

THE OLD HEADMASTER'S HOUSE (FLATS)

LOCKER ROOM FOR 6 LOCKERS (approx 10m<sup>2</sup>)

POSSIBLE POLICE OFFICE (space for 2 desks, approx 15m<sup>2</sup>)

6 covered cycle stands for Police use

Police Car Park Bay 1 (4.8 x 2.5m)

Police Car Park Bay 2 (4.8 x 2.5m)

MEETING ROOM (16m<sup>2</sup>)

Car Park Bay for Flat 1 (5.0 x 2.4m)

Car Park Bay for Flat 2 (5.0 x 2.4m)

Cycle Shelter for 6 cycles (for staff and public use)

Police/Staff Entrance

Possible police desk for front counter volunteer

LIBRARY

ENTRANCE FOYER

CAFE AREA (7.1m x 4.5m)

MALE TOILETS

FEMALE TOILETS

ACCESSIBLE TOILET

SERVERY

OFFICE

KITCHEN STORE (3.5m x 2m)

KITCHEN (3.5m x 4.5m)

Twyford Parish Council Parking Space (5.0 x 2.5m)

hard landscaping (at car park level)

FOOTPRINT OF OLD TOILET BLOCK TO BE DEMOLISHED  
EXISTING STEPS TO BE DEMOLISHED  
EXISTING RAMP TO BE DEMOLISHED

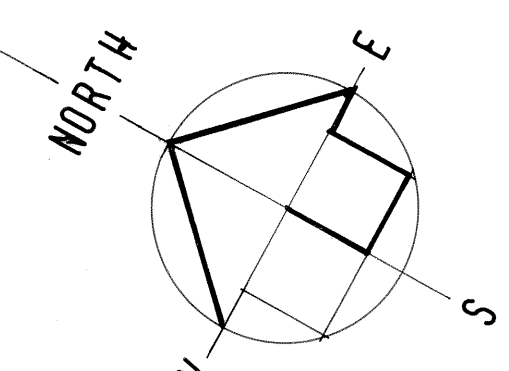
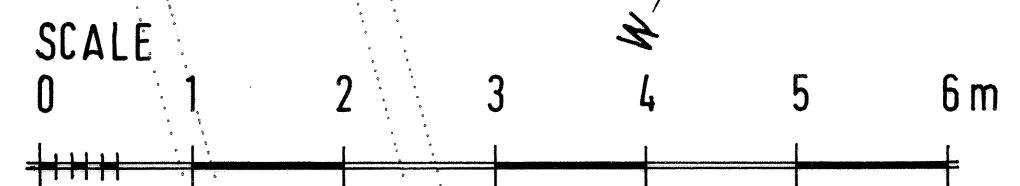

Do not scale from this drawing. Check dimensions on site.		Date: <b>JUNE '16</b>	Drawing Title: <b>UPPER GROUND FLOOR PLAN</b>
<b>SEDGMAN NOBLE architects</b> The Studio, Spring Meadows Business Centre, Highfield Farm, Wargrave, READING, RG10 8PZ Email: mail@sedgman-noble.co.uk Tel: 0118 940 4747		Scale: <b>1:50 @ A1</b>	Drawn: <b>FS</b>
Project: <b>THE EDWARD POLEHAMPTON CENTRE TWYFORD</b>	Job No: <b>398tbs</b>	Drawing No: <b>SK 11</b>	Revision: <b>A</b>